

BOM #	DESCRIPTION	PCS PART #	QTY
1	SAE4 TO SAE5 ADAPTER RING	TRN7014	1
2	M10X1.5X30mm FLANGED HEX BOLT	TRN7501	8

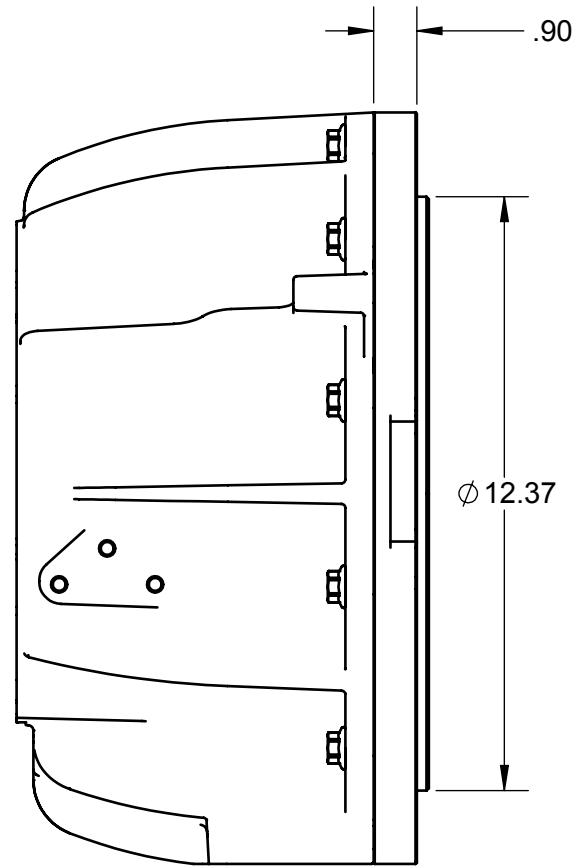

**ISO VIEW**  
INSTALLED  
SCALE: 1:4

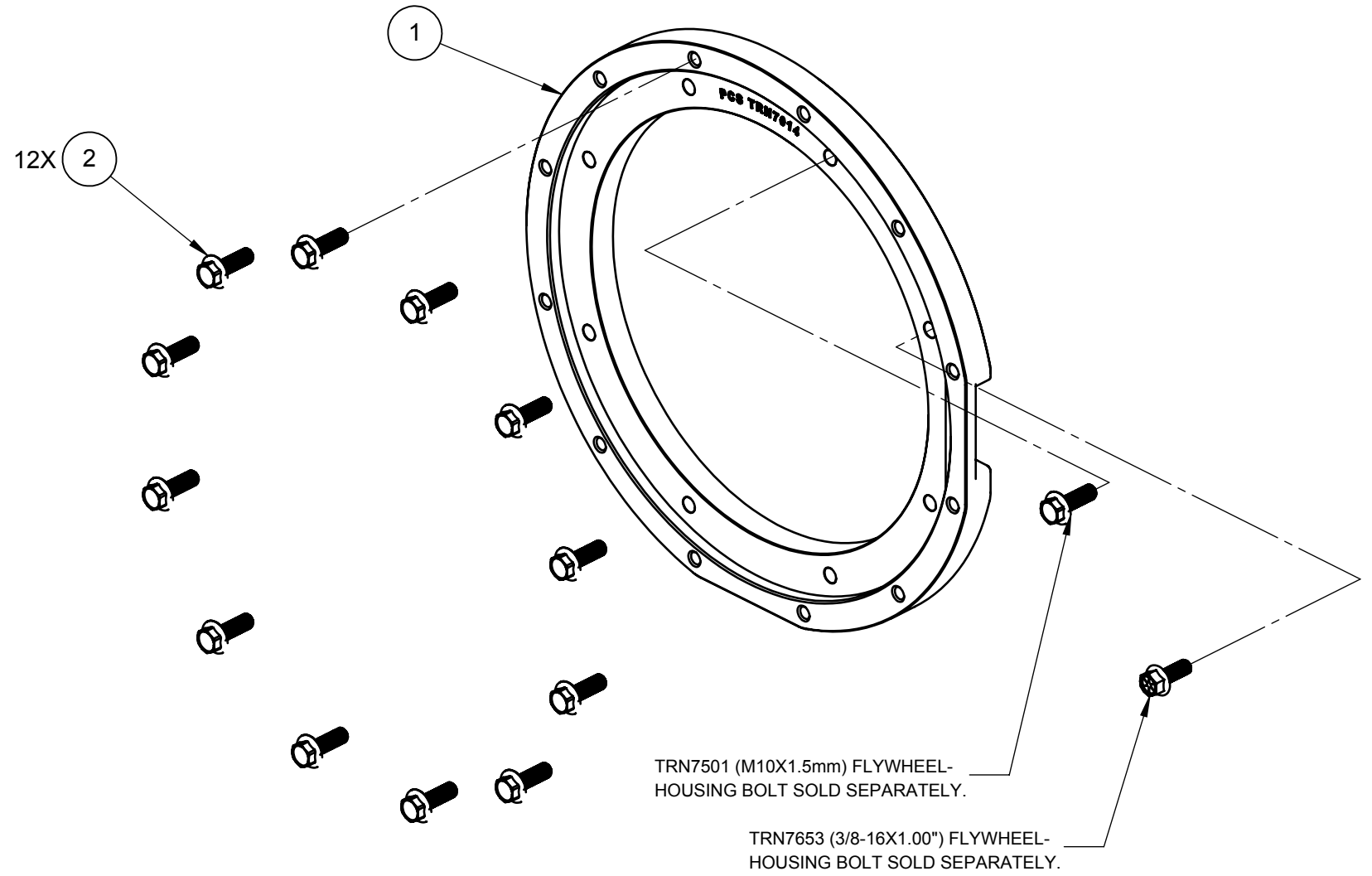

**EXPLODE VIEW**  
COMPONENTS  
SCALE: 1:4

**NOTES:**

1. INTERPRET THIS DRAWING IN ACCORDANCE WITH ASME Y14.5-2009.
2. THIS PRODUCT IS INTENDED AS A COUPLER BETWEEN AN SAE5 FLYWHEEL-HOUSING AND AN SAE4 BELLHOUSING (TRANSMISSION SIDE).
3. THIS ADAPTION KIT ADHERES TO SAE5 STANDARDS, BUT MAY ALSO BE COMPATIBLE WITH "BBS" OR "KBT" CONFIGURATIONS. CONSULT WITH PCS ENGINEERING FOR MORE DETAILS.
4. DO NOT INSTALL ANY DRIVELINE COMPONENTS THAT SHOW MANUFACTURING DEFECTS OR SHIPPING / HANDLING DAMAGES.
5. CONSULT THE ENGINE / FLYWHEEL HOUSING FOR MATING HARDWARE TORQUE SPECS. TORQUE SPECS FOR THE 11/12 BELLHOUSING TO BE 50-55 N\*m.
6. FLYWHEEL-HOUSING INTERFACE BOLTS ARE NOT SUPPLIED WITH THIS KIT, BUT ARE AVAILABLE SEPARATELY. REFERENCE YOUR FLYWHEEL-HOUSING FOR CORRECT THREAD PITCH AND DIAMETER.



DESCRIPTION	
<b>SAE4 TO SAE5 HOUSING ADAPTER KIT</b>	

**PROPRIETARY AND CONFIDENTIAL**  
THE INFORMATION CONTAINED IN THIS DRAWING IS THE SOLE PROPERTY OF PCS. ANY REPRODUCTION IN PART OR AS A WHOLE WITHOUT THE WRITTEN PERMISSION OF PCS IS PROHIBITED.

DRAWN BY	MFP	1/29/18
ENG APPR.		
DIMENSIONS ARE IN INCHES		SCALE: 1:8 SHEET 1 OF 1

USED ON	NEXT ASSEMBLY
SIZE	DRAWING NO.
<b>B</b>	TRN8378
	REV
	2